

TT-01

1/10 電動4WDレーシングカーシャーシキット
シャフトドライブ4WD TT-01 シャーシ
SHAFT DRIVEN 4WD

CHASSIS

1/10th SCALE R/C 4WD RACING CAR CHASSIS

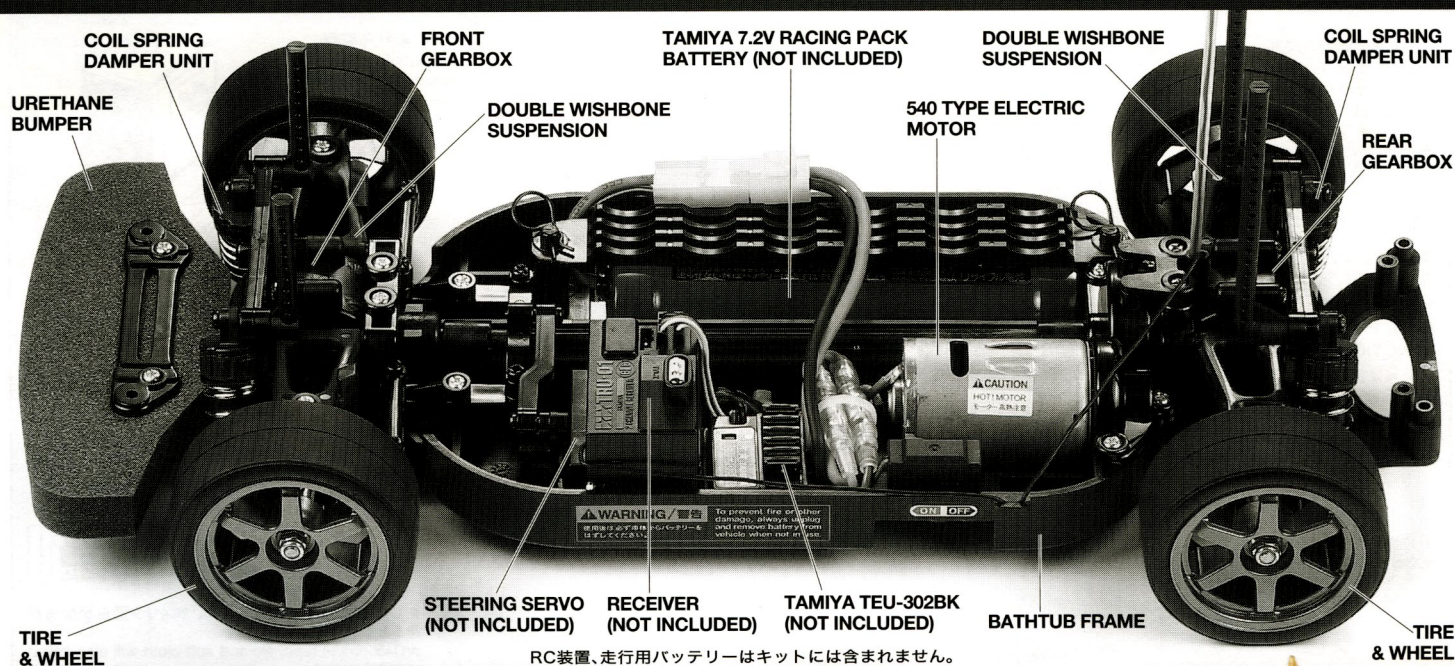
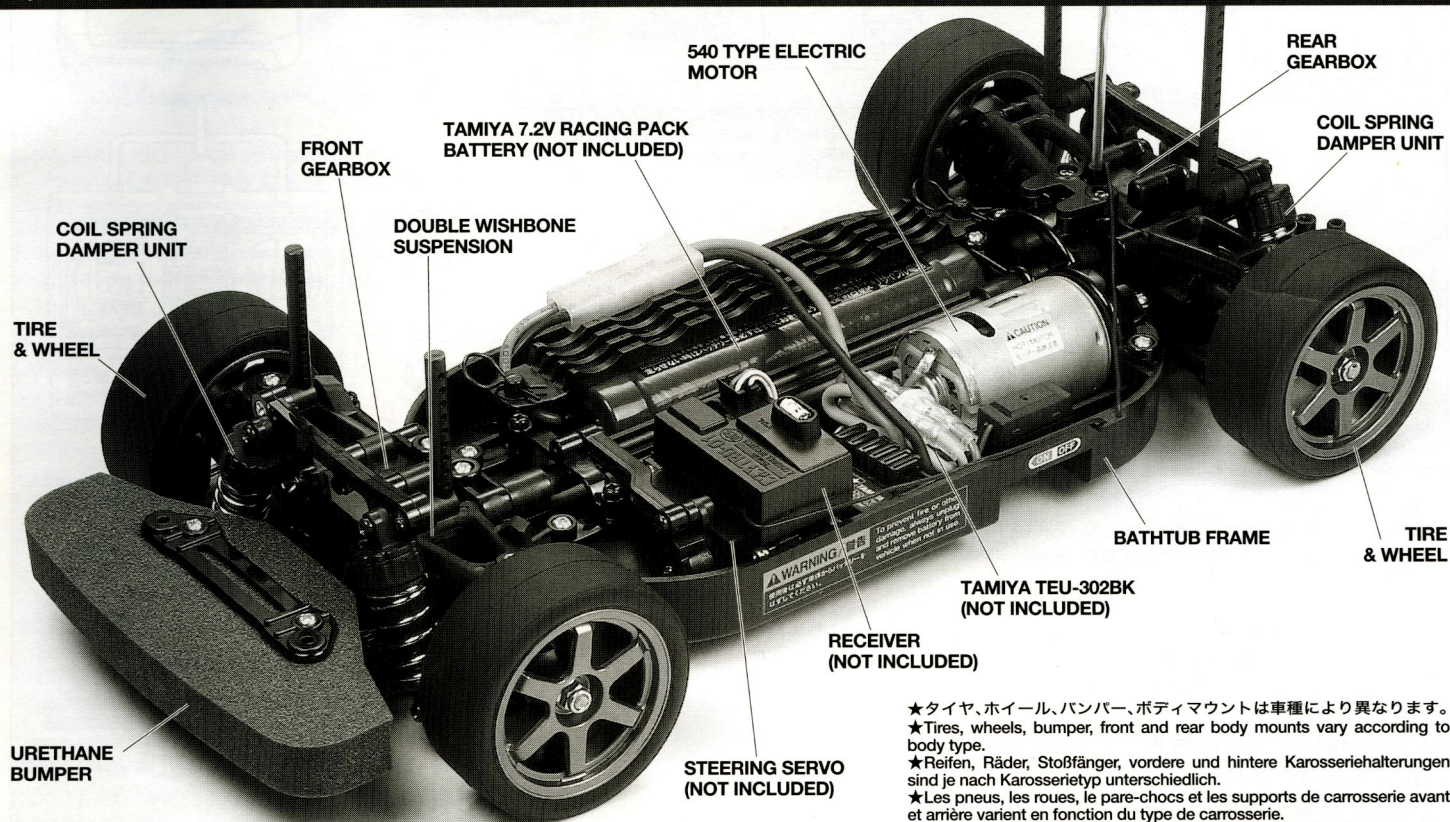

TAMIYA, INC.



3-7, ONDAWARA, SHIZUOKA-CITY, JAPAN.

PARTS

A

PARTS × 2
51002

★Aパーツは点線で示した部分のみ、さらにもう1セット入っています。
★Kit includes two A sprues - one whole A sprue and one more sprue that contains parts shown in the dot.
★Der Bausatz beinhaltet zwei A-Spritzlinge - einen vollständigen A-Spritzling und einen weiteren, der die Teile in den Rahmen enthält.
★La boîte contient 2 grappes A: une complète A et une ne contenant que les pièces dans les cadres.

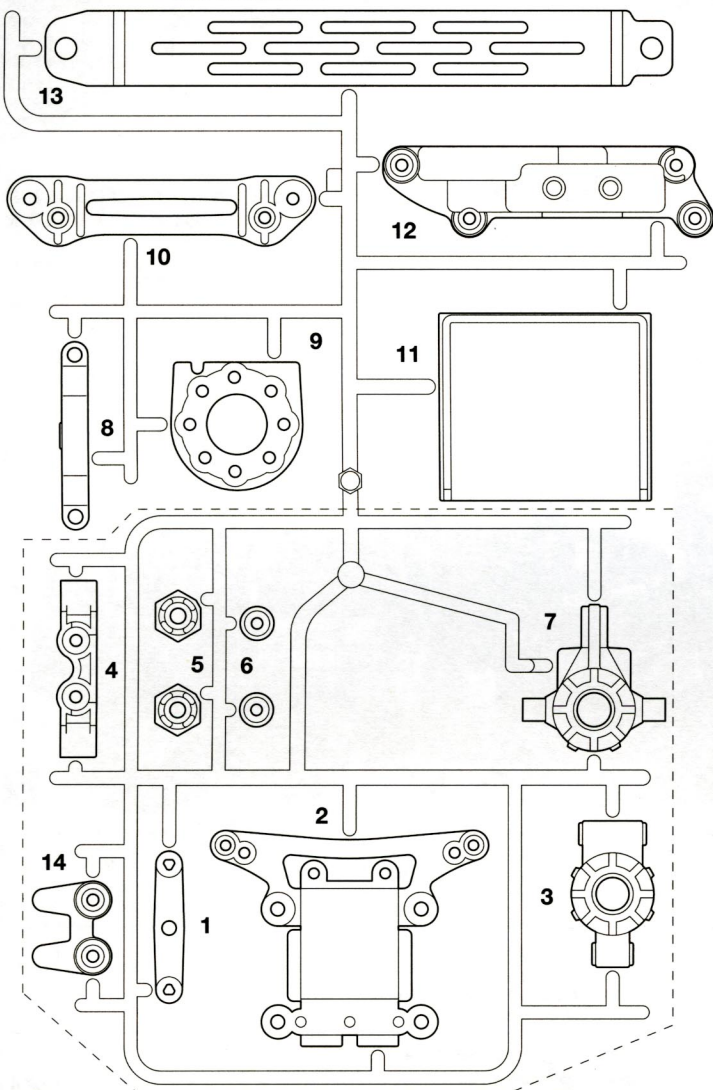

D

PARTS × 1
9005719

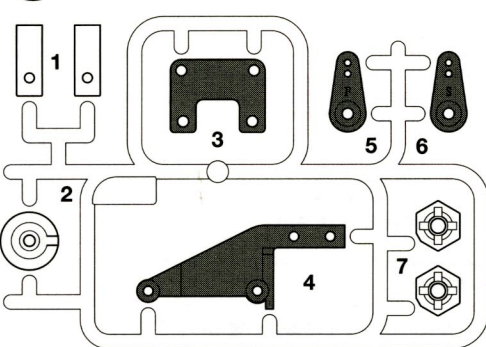

P

PARTS × 1
51005

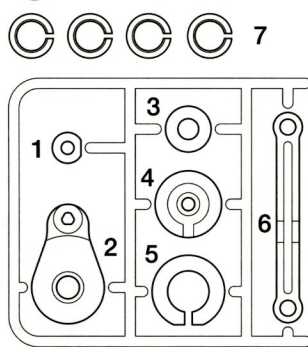

ホイールシャフト袋詰

9005713
9005718

Shaft bag
Shaft bag
Achsen-Beutel
Sachet d'arbres

SB1 × 1

プロペラシャフト
Propeller shaft
Antriebswelle
Arbre de transmission

SB2 × 1

リアプロペラジョイント
Rear propeller joint
Hinteres Antriebs-Gelenk
Accouplement d'arbre de transmission arrière

SB3 × 1

フロントプロペラジョイント
Front propeller joint
Vorderes Antriebs-Gelenk
Accouplement d'arbre de transmission avant

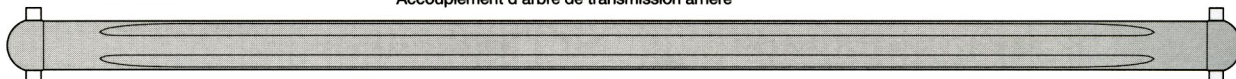

SB4 × 4
51006

ギヤボックスジョイント
Gearbox joint
Getriebegehäuse-Gelenk
Accouplement de pont

SB5 × 4
51006

ドライブシャフト
Drive shaft
Achswelle
Arbre d'entraînement

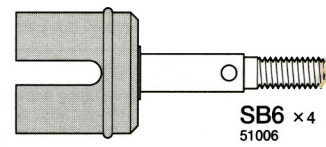
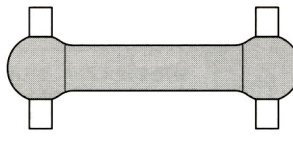
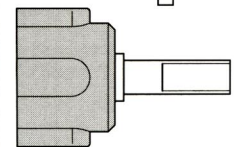

SB6 × 4
51006

※ホイールアクスル
※Wheel axle
※Radachse
※Axe de roue

B

PARTS × 2
51003

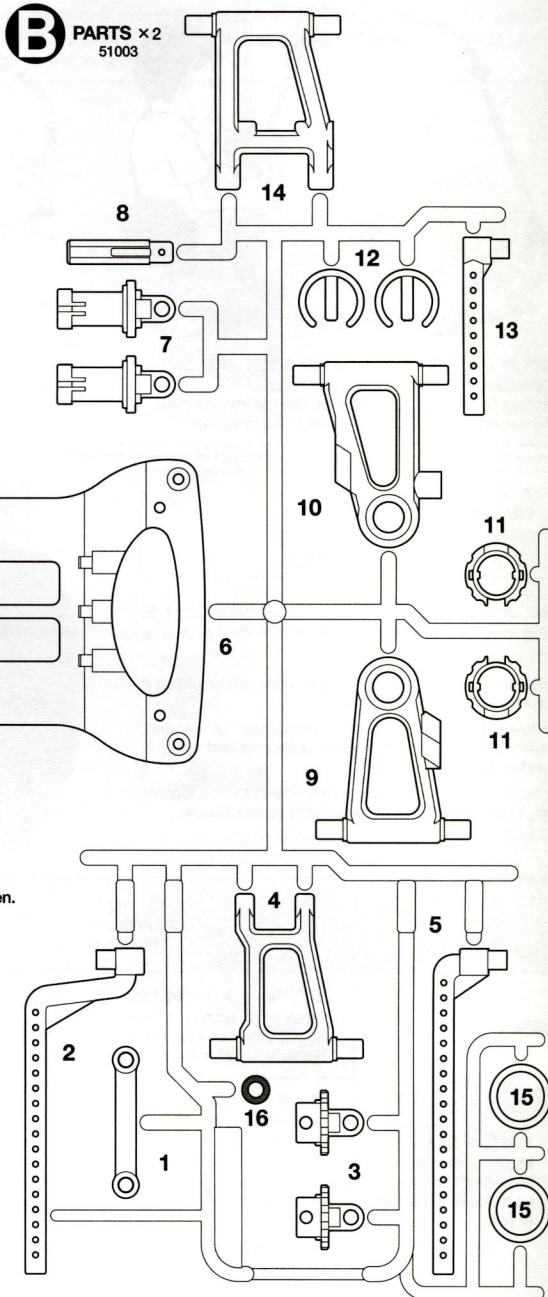

不要部品
Not used.
Nicht verwenden.
Non utilisées.

アンテナパイプ × 1
Antenna pipe 6095003
Antennenrohr
Gaine d'antenne

ウレタンバンパー × 1
Urethane bumper
Urethan-Stoßfänger
Pare-chocs en mousse

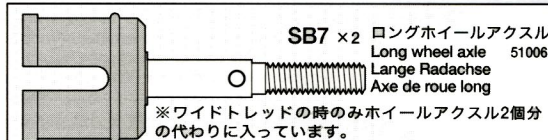

SB7 × 2 ロングホイールアクスル
Long wheel axle 51006
Lange Radachse
Axe de roue long

※ワイドトレッドの時のみホイールアクスル2個分の代わりに入っています。
※Wide tread version kit includes 2 long wheel axles instead of normal wheel axles. ※Der Bausatz mit breiter Spur enthält zwei lange Radachsen anstelle von normalen Radachsen.
※La version à voie large comprend 2 axes de roues longs à la place des axes de roues standards.

PARTS

★金具部品は少し多めに入っています。予備として使ってください。

★Extra screws and nuts are included. Use them as spares.

★Es liegen zusätzliche Schrauben und -muttern bei. Als Ersatzteile verwenden.

★Des vis et des écrous supplémentaires sont inclus. Les utiliser comme pièces de rechange.

ベアリング袋詰
Bearing bag
Lager-Beutel
Sachet de paliers



RB1
×12
0555015

1150プラベアリング
Plastic bearing
Plastik-Lager
Palier en plastique



RB2
×4

1280メタル
Metal bearing
Metall-Lager
Palier en métal

ギヤ袋詰 51004
Gear bag
Zahnrad-Beutel
Sachet de pignonerie



GB1
×2
ベベルピニオンギヤ
Bevel pinion gear
Kegelritzel
Pignon conique



GB2
×1
スパーギヤストッパー
Spur gear stopper
Stirnrad-Mitnehmer
Cale de pignon intermédiaire

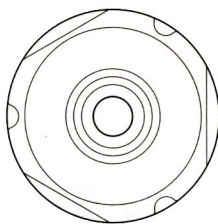

GB3
×2
デフキャリア
Differential gear case
Differentialgehäuse
Carter de différentiel

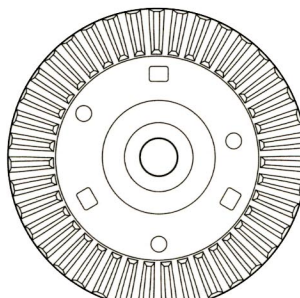

GB4
×2
リングギヤ
Ring gear
Tellerrad
Couronne

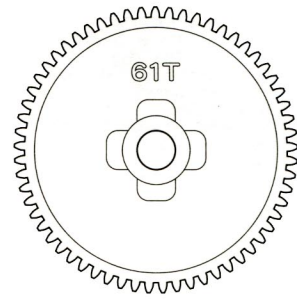

GB5
×1
61Tスパーギヤ
61T Spur gear
61Z Stirnradgetriebe
Pignon intermédiaire 61 dents

A 1~10
9415977



MA1
×4
9805629
3×12mmタッピングビス
Tapping screw
Schneidschraube
Vis taraudeuse



MA2
×7
50577
3×10mmタッピングビス
Tapping screw
Schneidschraube
Vis taraudeuse



MA3
×6
50578
3×10mmタッピングビス
Tapping screw
Schneidschraube
Vis taraudeuse



MA4
×2
9805636
3×6mm丸ビス
Screw
Schraube
Vis



MA5
×1
50576
3mmイモネジ
Grub screw
Madenschraube
Vis pointeau



MA6
×3
50573
2×8mmタッピングビス
Tapping screw
Schneidschraube
Vis taraudeuse

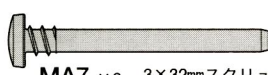

MA7
×2
9805756
3×32mmスクリューピン
Screw pin
Schraubzapfen
Cheville à vis

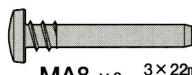

MA8
×2
9805755
3×22mmスクリューピン
Screw pin
Schraubzapfen
Cheville à vis

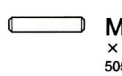

MA9
×1
50594
2×10mmシャフト
Shaft
Achse
Axe



MA10
×1
50355
19Tピニオンギヤ
19T Pinion gear
19Z Motorritzel
Pignon moteur 19 dents

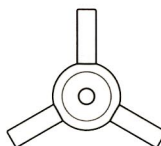

MA11
×1
51008
ベベルシャフト
Star shaft
Stern-Achse
Support de satellite

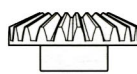

MA12
×2
51008
ベベルギヤ (大)
Large bevel gear
Kegelrad groß
Grand pignon conique



MA13
×3
51008
ベベルギヤ (小)
Small bevel gear
Kegelrad klein
Petit pignon conique

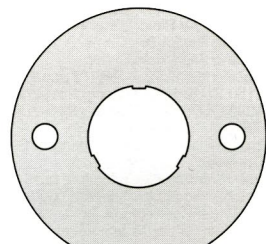

MA14
×1
4305125
モータープレート
Motor plate
Motor-Platte
Plaquette-moteur



六角棒レンチ.....×1
Hex wrench
Imbusschlüssel
Clé Allen 50038

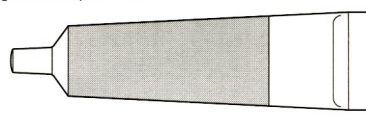

グリス.....×1
Grease
Fett
Graisse 87025

B 11~23
9415978



MA1
×2
9805629
3×12mmタッピングビス
Tapping screw
Schneidschraube
Vis taraudeuse



MA2
×11
50577
3×10mmタッピングビス
Tapping screw
Schneidschraube
Vis taraudeuse

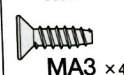

MA3
×4
50578
3×10mmタッピングビス
Tapping screw
Schneidschraube
Vis taraudeuse



MA6
×3
50573
2×8mmタッピングビス
Tapping screw
Schneidschraube
Vis taraudeuse

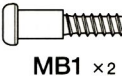

MB1
×2
9805945
3×18mm段付タッピングビス
Step screw
Paßschraube
Vis décollétée



MB2
×12
50582
3×14mm段付タッピングビス
Step screw
Paßschraube
Vis décollétée



MB3
×2
50586
3mmワッシャー
Washer
Beilagscheibe
Rondelle



MB4
×4
9805699
コイルスプリング
Coil spring
Spiralfeder
Ressort hélicoïdal

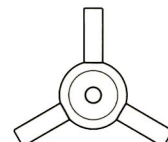

MA11
×1
51008
ベベルシャフト
Star shaft
Stern-Achse
Support de satellite

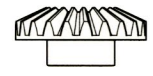

MA12
×2
51008
ベベルギヤ (大)
Large bevel gear
Kegelrad groß
Grand pignon conique



MA13
×3
51008
ベベルギヤ (小)
Small bevel gear
Kegelrad klein
Petit pignon conique

C 24~28
9400217



MA2
×3
50577
3×10mmタッピングビス
Tapping screw
Schneidschraube
Vis taraudeuse



MA3
×3
50578
3×10mmタッピングビス
Tapping screw
Schneidschraube
Vis taraudeuse

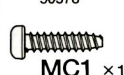

MC1
×1
50575
2.6×10mmタッピングビス
Tapping screw
Schneidschraube
Vis taraudeuse



MC2
×2
9805868
2×10mm丸ビス
Screw
Schraube
Vis



MB2
×4
50582
3×14mm段付タッピングビス
Step screw
Paßschraube
Vis décollétée



MB3
×2
50586
3mmワッシャー
Washer
Beilagscheibe
Rondelle



MC3
×2
9805758
2mmワッシャー
Washer
Beilagscheibe
Rondelle



MC4
×4
9805557
4mmフランジロックナット
Flange lock nut
Sicherungsmutter
Ecrou nylstop à flasque

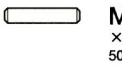

MA9
×4
50594
2×10mmシャフト
Shaft
Achse
Axe



MC5
×8
50197
スナップピン (小)
Snap pin (small)
Federstift (klein)
Epingle métallique (petite)

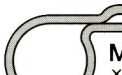

MC6
×2
50197
スナップピン (大)
Snap pin (large)
Federstift (groß)
Epingle métallique (grande)

両面テープ.....×1
Double-sided tape
Doppelklebeband
Adhésif double face 50171

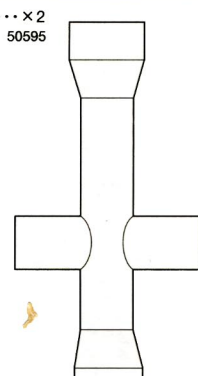

十字レンチ.....×1
Box wrench
Steckschlüssel
Clé à tube 50038

AFTER MARKET SERVICE CARD

When purchasing Tamiya replacement parts, please take or send this form to your local Tamiya dealer so that the parts required can be correctly identified and supplied. Please note that specifications, availability and price are subject to change without notice.

KUNDENNACHBETREUUNGS-KARTE

Wenn Sie TAMIYA-Ersatzteile kaufen möchten, nehmen Sie bitte zur Unterstützung dieses Formular mit zu Ihrem örtlichen Fachhändler. Bezüglich der Angaben, der Lagerhaltung der Artikel und der Preise sind Änderungen vorbehalten.

SERVICE APRES-VENTE

LISTE DE PIECES DETACHEES

Afin de vous permettre de vous procurer des pièces de rechange Tamiya, amenez cette liste à votre point de vente Tamiya qui ne manquera pas de vous renseigner. Veuillez noter que les caractéristiques, disponibilité et prix peuvent changer sans avis préalable.

PARTS CODE

51001	TT-01 Chassis		
51002	TT-01 A Parts (Upright) (A1-A14)		
	(One whole A sprue and one more A1-7, A14 half-sprue for one car)		
51003	TT-01 B Parts (Suspension Arm) (B1-B16, 2 pcs.)		
9005719	D Parts (D1-D7)		
51005	TT-01 P Parts (Servo Horn) (P1-P7)		
9005713	Wheel Shaft Bag		
	Propeller Shaft (SB1) x1	Rear Propeller Joint (SB2) x1	
	Front Propeller Joint (SB3) x1	Gear Box Joint (SB4) x4	
	Drive Shaft (SB5) x4	Wheel Axle (SB6) x4	
9005718	Wheel Shaft Bag (for Wide Tread)		
	Propeller Shaft (SB1) x1	Rear Propeller Joint (SB2) x1	
	Front Propeller Joint (SB3) x1	Gear Box Joint (SB4) x4	
	Drive Shaft (SB5) x4	Wheel Axle (SB6) x2	
	Long Wheel Axle (SB7) x2		
51006	*1 TT-01 Drive Shaft Set (SB4-SB7, 2 pcs. each)		
51004	TT-01 G Parts (Gear)		
	Bevel Pinion Gear (GB1) x2	Spur Gear Stopper (GB2) x1	

	Diff. Gear Case (GB3) x2	Ring Gear (GB4) x2	
	61T Spur Gear (GB5) x1		
0555015	1150 Plastic Bearing (RB1 x10)		
9415977	Metal Parts Bag A		
9415978	Metal Parts Bag B		
9400217	Metal Parts Bag C		
9805629	3x12mm Tapping Screw (MA1 x4)		
50577	3x10mm Tapping Screw (MA2 x10)		
50578	3x10mm Countersunk Tapping Screw (MA3 x10)		
9805636	3x6mm Screw (MA4 x2)		
50576	3mm Grub Screw (MA5 x10)		
50038	Tool Set (Box Wrench, Hex Wrench, MA5 x4)		
50573	2x8mm Tapping Screw (MA6 x10)		
9805756	3x32mm Screw Pin (MA7 x4)		
9805755	3x22mm Screw Pin (MA8 x4)		
50594	2x10mm Shaft (MA9 x10)		
50355	*2 18T, 19T AV Pinion Gear Set (MA10...etc.)		
51008	*1 Bevel Gear Set (TT-01, TGS) (MA11 x1, MA12 x2, MA13 x3)		
4305125	Motor Plate (MA14)		

9805945	3x18mm Step Screw (MB1 x2)		
50582	3x14mm Step Screw (MB2 x5)		
50586	3mm Washer (MB3 x15)		
9805699	*1 Coil Spring (MB4 x2)		
50575	2.6x10mm Tapping Screw (MC1 x5)		
9805868	2x10mm Screw (MC2 x10)		
9805758	2mm Washer (MC3 x5)		
9805557	4mm Flange Lock Nut (MC4 x4)		
50197	Snap Pin Set (MC5 x5, MC6 x10)		
50171	Heat Resistant Double-Sided Tape		
50595	Nylon Band w/Metal Hook (10 pcs.)		
87025	Ceramic Grease		
45029	ESC TEU-101BK		
	Instructions x1	ESC (TEU-101BK) x1	
53689	540-J Motor		
6095003	Antenna Pipe (30cm)		
1050389	Instructions (for Chassis)		
*1	Requires 2 sets for one car.		
*2	Only 19T and 22T can be used.		

TAMIYA SPARE PARTS & HOP-UP OPTIONS

Tamiya offers Spare Parts & Hop-Up Options for improved performance at the track. Visit your local Tamiya dealer for assistance. Please note that specifications, availability and price are subject to change without notice.

TAMIYA ERSATZTEILE & HOP-UP-TEILE

Für bessere Fahrleistung auf der Piste bietet TAMIYA Ersatzteile und Hop-Up-Teile an. Besuchen Sie Ihren örtlichen Fachhändler, er wird Ihnen helfen. Bezüglich der Angaben, der Lagerhaltung der Artikel und der Preise sind Änderungen vorbehalten.

PIECES DETACHEES ET OPTIONNELLES

Tamiya propose des pièces détachées et optionnelles pour améliorer les performances sur la piste. Rendez-vous chez votre détaillant habituel pour tous renseignements. Veuillez noter que les caractéristiques, disponibilités et prix peuvent changer sans avis préalable.

ITEM No.			
50356	20T, 21T AV Pinion Gear Set		
50357	*2 22T, 23T AV Pinion Gear Set		
50419	Racing Radial Tires (2 pcs.)		
50454	Racing Slick Tires (2 pcs.)		
50810	Racing Semi-Slick Tires (2 pcs.)		
53008	1150 Sealed Ball Bearing Set (4 pcs.)		
53066	1280 Sealed Ball Bearing Set (3 pcs.)		
53068	RS-540 Sport-Tuned Motor		
53155	Low Friction Aluminum Damper Set (2 pcs.)		
53163	On-Road Tuned Spring Set		
53293	Reinforced Slicks Type-A (2 pcs.)		
53294	Reinforced Slicks Type-B (2 pcs.)		
53295	Tire Inner Foam (4 pcs.)		
53339	CA Cement (for Rubber Tires)		

53439	Anti-Wear Grease		
53448	4mm Hard Lock-Nut & Spacer Set		
53497	TT-01 Ball Bearing Set		
53569	Clamp Type Aluminum Wheel Hub (6mm Thick)		
53571	TRF Damper Set (Fluorine Coated, 4 pcs.)		
53619	C.V.A. Mini Shock Unit Cylinder (4 pcs.)		
53620	TT-01 Aluminum Propeller Shaft		
53646	Wheel Spacer (Blue)		
53647	Wheel Spacer (Red)		
53662	TT-01 Turnbuckle Tie-Rod Set		
53663	TT-01 Ball Diff. Set		
53664	TT-01 Aluminum Motor Heat Sink		
53665	TT-01 Spur Gear Set (55T/58T)		
53666	TT-01 Metal Motor Mount		
53670	TT-01 Aluminum Racing Steering Set		

53671	TT-01 Front One-Way Unit		
53672	TT-01 Carbon Upper Frame		
53673	Toe-in Rear Upright (TT-01, TGS)		
53674	Adjustable Upper Arm Set (TT-01, TGS)		
53682	Aluminum Bumper Stopper (TT-01, TGS)		
53694	TT-01 Stabilizer Set (Front)		
53695	TT-01 Stabilizer Set (Rear)		
53696	Super Stock Motor TZ		
53697	Super Stock Motor RZ		
53779	GT-Tuned Motor (25T)		
53792	TT-01 Universal Shaft Set (2 pcs.)		
53800	TT-01 Aluminum Toe-in Rear Upright		
53834	Tire Inserts (Soft) for 26mm Tire		
53835	Tire Inserts (Hard) for 26mm Tire		
53864	TT-01 Aluminum Steering Link		